

COLES COUNTY BOARD
Regular Meeting
November 9, 2016

The regular meeting of the Coles County Board was called to order at 7:00 p.m. with the following members present, Brandon Bell, Paul Daily, Mark Degler, Jan Eads, Dan Lawrence, Brian Marvin, Nancy Purdy, Cory Sanders, and Marc Weber, with Chairman Stan Metzger presiding. Absent were members Ron Osborne and Mike Zuhone.

Following the Pledge to the Flag, the Invocation was given by Marc Weber.

Motion was made by Sanders, seconded by Marvin to approve the October 11, 2016 County Board minutes and the Review of Closed Minutes from August 9, 2016

For a copy of the Review of Closed Minutes see page 3368

AYES: Bell, Daily, Degler, Eads, Lawrence,
Marvin, Metzger, Purdy, Sanders, Weber (10)

NAYS: None (0)

ABSENT: Osborne, Zuhone (2)

APPROVAL OF THE BUDGET ENDING NOVEMBER 30, 2017

Motion was made by Lawrence, seconded by Marvin to approve the 2016-2017 Budget with the consent of the Coles County Board.

For a copy of the Budget see pages 3369 - 3429

AYES: Bell, Daily, Degler, Eads, Lawrence,
Marvin, Metzger, Purdy, Sanders, Weber (10)

NAYS: None (0)

ABSENT: Osborne, Zuhone (2)

APPROVAL OF THE 2017 - HOLIDAY CALENDAR

For a copy of the Holiday Calendar see page 3430

Upon motion by Sanders, seconded by Daily

AYES: Bell, Daily, Degler, Eads, Lawrence,
Marvin, Metzger, Purdy, Sanders, Weber (10)

NAYS: None (0)

ABSENT: Osborne, Zuhone (2)

**RESOLUTION AUTHORIZING EXECUTION AND AMENDMENT OF DOWNSTATE
OPERATING ASSISTANCE GRANT AGREEMENT # 4746 DIAL-A-RIDE**

And

**RESOLUTION AUTHORIZING EXECUTION AND AMENDMENT OF DOWNSTATE
OPERATING ASSISTANCE GRANT AGREEMENT # 4682 DIAL-A-RIDE**

For a copy of the resolutions see pages 3431 - 3432

Upon motion by Daily, seconded by Degler

AYES: Bell, Daily, Degler, Eads, Lawrence,
Marvin, Metzger, Purdy, Sanders, Weber (10)
NAYS: None (0)
ABSENT: Osborne, Zuhone (2)

**INTERGOVERNMENTAL AGREEMENT FOR
STRUCTURE REPLACEMENT PROJECT
SECTION 16-01137-00-BR
STRUCTURE NO: 015-3113
TR 137B IN ASHMORE TOWNSHIP**

For a copy of the agreement see pages 3433 - 3434

Motion by Weber, seconded by Bell

AYES: Bell, Daily, Degler, Eads, Lawrence,
Marvin, Metzger, Purdy, Sanders, Weber (10)
NAYS: None (0)
ABSENT: Osborne, Zuhone (2)

**ENGINEERING SERVICE AGREEMENT WITH ESI CONSULTANTS
16-01137-00-BR**

For a copy of the agreement see pages 3435 - 3438

Motion by Weber, seconded by Daily

AYES: Bell, Daily, Degler, Eads, Lawrence,
Marvin, Metzger, Purdy, Sanders, Weber (10)
NAYS: None (0)
ABSENT: Osborne, Zuhone (2)

**COUNTY BRIDGE FUND PETITION - SEVEN HICKORY
PROJECT #12-08-2016 STRUCTURE #015-3245**

For a copy of the petition see pages 3439 - 3441

Motion by Weber, seconded by Bell

AYES: Bell, Daily, Degler, Eads, Lawrence,
Marvin, Metzger, Purdy, Sanders, Weber (10)

NAYS: None (0)

ABSENT: Osborne, Zuhone (2)

**COUNTY BRIDGE FUND PETITION - ASHMORE ROAD
PROJECT #01-10-2016 STRUCTURE # 3152, 3233, 3263**

For a copy of the petition see pages 3442 - 3444

Motion by Weber, seconded by Daily

AYES: Bell, Daily, Degler, Eads, Lawrence,
Marvin, Metzger, Purdy, Sanders, Weber (10)

NAYS: None (0)

ABSENT: Osborne, Zuhone (2)

APPOINTMENTS

None

PRESENTATION OF PLAQUE

Chairman Metzger presented Dan Lawrence a plaque for 12 years of service on the Coles County Board.

ADJOURNED

Upon motion by Lawrence, seconded by Degler, the Coles County Board was adjourned at 7:25 p.m..

ATTEST:



County Clerk

REVIEW OF CLOSED MINUTES

Coles County Board - Executive Session Minutes - August 9, 2016

The meeting was called to order at 7:28 p.m. by Chairman Stan Metzger.

Members present :

Brandon Bell, Paul Daily, Jan Eads, Dan Lawrence, Brian Marvin, Ron Osborne, Cory Sanders, Marc Weber, Michael Zuhone, and Stan Metzger.
Absent were members Mark Degler and Nancy Purdy.

Others in attendance:

Brian Bower, Elaine Karpus Komada, Carol Figgins, Kelly Lockhart, Melissa Hurst, Rick Johnson, George Edwards, Monty Walters, and James Rankin.

Purpose:

Accusation of Real Estate (CTF Building)

Matters discussed

- *Interest from the Board
- *Inspection and cost estimates
- *Letter of Intent
- *Appointed Kelly Lockhart, Cory Sanders, and Stan Metzger to look into the building for price studies, engineer study and estimate costs
- *Kelly Lockhart to compare a cost of a new building
- *Formal Board Approval

Following the discussion, the committee returned to open session at 8:03 p.m..

COLES COUNTY, ILLINOIS
BUDGET INFORMATION FOR
THE
FISCAL YEAR ENDING
NOVEMBER 30, 2017

Prepared by the Coles County Finance/Tax Levy
Committee

Committee Members

Stan Metzger, Chairman
Brandon Bell
Brian Marvin
Marc Weber
Dan Lawrence

ANNUAL BUDGET ORDINANCE

WHEREAS, the County Board, Coles County, Illinois, finds the sums of money as set forth in the Budget for the ensuing fiscal year ending the 30th day of November, AD, 2017 to be necessary appropriations of and for the County of Coles, State of Illinois.

BE IT ORDAINED BY THE COUNTY BOARD, COLES COUNTY, ILLINOIS:

That the appropriations as proposed in the Annual Budget be adopted as that for the County of Coles, State of Illinois, for the fiscal year ending the 30th day of November, 2017.

ADOPTED this ____ day of _____, 2016.

Chairman
Coles County Board

ATTEST:

County Clerk

ANNUAL LEVY ORDINANCE

An ordinance levying taxes for all corporate purposes for the COUNTY OF COLES, ILLINOIS, for the fiscal year commencing on the 1st day of December, AD, 2016, and ending on the 30th day of November, AD, 2017.

BE IT ORDAINED BY THE COUNTY BOARD, COLES COUNTY, ILLINOIS:

SECTION 1: That the amounts hereinafter set forth, or so much thereof as may be authorized by law, and the same is hereby levied for such purposes as: Corporate Tax, Special Services Tax, County Highway Tax, County Construction of Bridges Tax, County Highway Matching Tax, Illinois Municipal Retirement Tax, Tuberculosis Tax, General and Liability Insurance Tax, Workers' Compensation Tax, Unemployment Insurance Tax, Social Security Tax, Senior Citizens Social Services Tax, and Mental Health Tax, for the fiscal year of the said COUNTY OF COLES, ILLINOIS, beginning the 1st day of December, 2016, and ending the 30th day of November, 2017.

SECTION 2: The amount levied for each object and purpose is detailed in the attached budget revenue and expense worksheets and summarized as follows:

	<u>Total Budgeted</u>	<u>To Be Paid By Sources Other Than Taxation</u>	<u>Amounts To Be Paid By Taxation</u>
1. General Fund	<u>\$12,905,640</u>	<u>\$9,384,640</u>	<u>\$3,520,000*</u>
* Said amount is hereby levied as the:			
Corporate Tax (55 ILCS 5/5-1024 – maximum .27%)			1,990,000
Special Services Tax (Coles County Case No. 72-MR-416)			1,530,000
2. County Highway	<u>614,000</u>	<u>97,108</u>	<u>516,892*</u>
* Said amount is hereby levied as the County Highway Tax (605 ILCS 5/5-601 – maximum .10%)			
3. County Construction of Bridges	<u>875,000</u>	<u>579,659</u>	<u>295,341*</u>
* Said amount is hereby levied as the County Construction of Bridges Tax (605 ILCS 5/5-602 - maximum .05%)			
4. County Highway Matching	<u>1,061,400</u>	<u>766,059</u>	<u>295,341*</u>
* Said amount is hereby levied as the County Highway Matching Tax (605 ILCS 5/5-603 - maximum .05%)			
5. Tipping Fee	<u>66,000</u>	<u>66,000</u>	
6. Emergency Telephone System	<u>1,491,007</u>	<u>1,491,007</u>	

7. Illinois Municipal Retirement	<u>2,020,400</u>	<u>707,500</u>	<u>1,312,900*</u>
* Said amount is hereby levied as the Illinois Municipal Retirement Tax (40 ILCS 5/7-171, 5/7-132 – no maximum)			
8. Tuberculosis	<u>115,075</u>	<u>2,220</u>	<u>112,855*</u>
* Said amount is hereby levied as the Tuberculosis Tax (70 ILCS 920/5.3 – maximum .075%)			
9. Special Services	<u>1,031,500</u>	<u>500</u>	<u>1,031,000*</u>
* Said amount is hereby levied as the:			
General and Liability Insurance Tax (745 ILCS 10/9-107 – no max)			230,000
Workers' Compensation Tax (745 ILCS 10/9-107 – no maximum)			120,000
Unemployment Insurance Tax (745 ILCS 10/9-107 – no maximum)			00
Social Security Tax (40 ILCS 5/21-110, 5/21-110.1 – no maximum)			681,000
10. Senior Citizens	<u>156,000</u>		<u>156,000*</u>
*Said amount is hereby levied as the Senior Citizens Social Services Tax (55 ILCS 5/5-1034 – maximum .025%)			
11. Public Health	<u>1,069,520</u>	<u>1,069,520</u>	
12. Mental Health	<u>1,386,050</u>	<u>411,050</u>	<u>975,000*</u>
*Said amount is hereby levied as the Mental Health Tax (55 ILCS 5/5-25025 – Maximum .15%)			
13. 1999 Alternative Bond Fund	<u>155,655</u>	<u>155,655</u>	

RECAPITULATION

Corporate Tax	\$1,990,000
Special Services Tax	1,530,000
County Highway Tax	516,892
County Construction of Bridges Tax	295,341
County Highway Matching Tax	295,341
Illinois Municipal Retirement Tax	1,312,900
Tuberculosis Tax	112,855
General and Liability Insurance Tax	230,000
Workers' Compensation Tax	120,000
Unemployment Insurance Tax	0
Social Security Tax	681,000
Senior Citizens Social Services Tax	156,000
Mental Health Tax	<u>975,000</u>
 Grand Total of all Taxes	 <u>\$8,215,329</u>

SECTION 3: That the County Clerk of said COUNTY OF COLES is hereby directed to extend the aforesaid tax in the amounts above set forth for the fiscal year of COUNTY OF COLES beginning December 1, 2016 and ending November 30, 2017.

SECTION 4: Partial invalidity. That if any section, subdivision, sentence or word of this Ordinance is for any reason held void or invalid or to be unconstitutional, such decision shall not affect the validity of the remaining portions of this Ordinance.

SECTION 5: This ordinance shall be in full force and effect from and after its passage, approval and recording, according to Law.

ADOPTED this ____ day of _____, 2016.

Chairman
Coles County Board

ATTEST:

County Clerk

000 COUNTY GENERAL

Fiscal year thru period ending 12/31/2016

Description	Revision 2	Budget Approved
001-4001-000-000 PROPERTY TAXES-GENERAL	1,990,000	
001-4003-000-000 MOBILE HOME TAX	5,000	
001-4004-000-000 REPLACEMENT TAX	80,000	
001-4005-000-000 STATE INCOME TAX	1,175,000	
001-4006-000-000 SALES TAX-CO RETAILERS	216,000	
001-4008-000-000 SOCIAL SECURITY REIMBUR	678,390	
001-4010-000-000 PROPERTY TAX-SPECIAL SE	1,530,000	
001-4011-000-000 CO SALES TAX-SUPPLEMENT	1,500,000	
001-4013-000-000 INCOME TAX USE TAX	260,000	
001-4017-000-000 CITIES INCOME	59,000	
001-4018-000-000 REGISTRATION	60,000	
001-4019-000-000 DONATIONS-ANIMAL SHELTE	30,000	
001-4020-000-000 TREASURERS INDEMNITY FU	10,000	
001-4021-000-000 SHELTER INCOME	35,000	
001-4022-000-000 COURT SECURITY FEE	177,000	
001-4023-000-000 WORK RELEASE FEES	6,000	
001-4028-000-000 CASA FEES	18,000	
001-4030-000-000 COURT FEE FUND	66,000	
001-4033-000-000 PRETRIAL-COURT SERVICES	11,500	
001-4039-000-000 TREASURERS FEES	8,000	
001-4040-000-000 CORONER TRANSCRIPTS & F	9,000	
001-4041-000-000 COUNTY CLERK FEES	200,000	
001-4042-000-000 CO CLK-REVENUE STAMPS	81,000	

000 COUNTY GENERAL

Fiscal year thru period ending 12/31/2016

Description	Revision 2	Budget Approved
001-4043-000-000 CIRCUIT CLERK FEES	400,000	
001-4045-000-000 SHERIFF FEES	270,000	
001-4046-000-000 STS ATTORNEY-FINES AND	450,000	
001-4047-000-000 CIR CLK-PUBLIC DEFENDER	40,000	
001-4050-000-000 RECORD STORAGE-REIMBURS	145,000	
001-4051-000-000 VITAL RECORDS AUTOMATIO	14,000	
001-4054-000-000 COURT AUTOMATION REIMB	182,435	
001-4056-000-000 TREASURERS EQUIPMENT RE	32,000	
001-4057-000-000 STS ATTY RECORDS AUTOMA	5,000	
001-4059-000-000 RESTRICTED FUNDS-STs AT	10,000	
001-4060-000-000 COLES TOGETHER SAL REIM	200,000	
001-4061-000-000 STATES ATTORNEYS SAL-RE	156,000	
001-4062-000-000 ASST STS ATTORNEY-SAL R	7,200	
001-4063-000-000 PROBATION DIRECTOR-OFFI	430,045	
001-4064-000-000 SUPERV OF ASSESS-SALARY	27,500	
001-4066-000-000 EMERGENCY DISASTER-REFU	18,950	
001-4067-000-000 PUBLIC DEFENDER SALARY	105,600	
001-4068-000-000 CUMBERLAND CO PROB-SALA	45,000	
001-4069-000-000 CHILD SUPPORT MTCE-REIM	35,235	
001-4071-000-000 PROBATION FEES-STATE SH	66,105	
001-4072-000-000 LIABILITY/WORKMENS COMP	350,000	
001-4073-000-000 UNEMPLOYMENT INS-REIMB	10,000	
001-4074-000-000 ETSB-FRINGES REIMBURSEM	55,000	

000 COUNTY GENERAL

Fiscal year thru period ending 12/31/2016

Description	Revision 2	Budget Approved
001-4075-000-000 EMPLOYEE SHARE HTH INS	490,500	
001-4077-000-000 DOCUMENT STORAGE REIMBU	158,165	
001-4078-000-000 POLICE TRAINING-REIMB	30,000	
001-4079-000-000 COURT ORDERED RESTITUTI	5,000	
001-4081-000-000 INTEREST-EARNED-CO TREA	5,000	
001-4082-000-000 INTEREST-COLLECTORS FUN	500	
001-4083-000-000 GIS FRINGES	2,000	
001-4084-000-000 HOST FEES	55,000	
001-4085-000-000 MISC-RENTS-REFUNDS	90,000	
001-4086-000-000 FUEL REIMBURSEMENT	110,000	
001-4087-000-000 HEALTH INS REIMB-OTHER	218,680	
001-4089-000-000 TAX PENALTIES-COSTS-CO	120,000	
001-4101-000-000 CIRCUIT CLERK E-CITATIO	8,200	
001-4102-000-000 SHERIFF E-CITATION	1,500	
001-4103-000-000 SHF DRUG PREVENTION	14,000	
001-4104-000-000 SHF DUI EQUIPMENT	35,000	
001-4105-000-000 SHERIFF K-9	27,900	
001-4106-000-000 CIR CLK OP & ADMIN FUND	7,136	
001-4113-000-000 SHF CRIME PREVENTION	5,800	
001-4114-000-000 SHF INMATE TELEPHONE PR	74,000	
001-4115-000-000 SHF SEX OFFENDER REGIST	580	
001-4119-000-000 PROBATION-SPECIAL OPERA	10,000	
001-4145-000-000 DIVERSION PROGRAMS	5,000	

000 COUNTY GENERAL

Fiscal year thru period ending 12/31/2016

Description	Revision 2	Budget Approved
001-4148-000-000 COPIES	15,000	
001-4149-000-000 ARRA SEX OFFENDER GRANT	64,719	
001-4181-000-000 ELECTRIC AGGREGATION FE	15,000	
001-4183-000-000 JAIL INMATE MEDICAL REI	15,000	
001-4184-000-000 POLICE VEHICLE FUND	3,000	
001-4186-000-000 CO GEN ADMIN REIMB	34,000	
001-4285-000-000 LIQUOR LICENSE	4,500	
001-4288-000-000 VIDEO GAMING	500	
001-4289-000-000 FRANCHISE FEE	20,000	
	-----	-----
Total Revenue	12,905,640	
	-----	-----

Run date: 10/11/2016 @ 14:35
 Bus date: 12/01/2016

Coles County
 Revenue and Expense Worksheet

Select...: A001-XXXX-XXX-XXX
 E:\Carla\BUB Page 5

001 COUNTY ADMINISTRATION

Fiscal year thru period ending 12/31/2016

Description	Revision 2	Budget Approved
001-7011-001-000 COUNTY BOARD-SALARIES	58,800	
001-7012-001-000 COUNTY BOARD-MILEAGE	7,500	
001-7050-001-000 COLES TOGETHER SALARY	200,000	
001-7051-001-000 SALARY-CO BOARD SECRETARY	46,360	
001-7085-001-000 EMPLOYER HEALTH INSURANCE	981,500	
001-7090-001-000 UNEMPLOYMENT COMPENSATION	10,000	
001-7093-001-000 CO SHARE-SOCIAL SECURITY	678,390	
001-7112-001-000 POSTAGE-EQUIP & MTCE	4,000	
001-7130-001-000 INSURANCE	350,000	
001-7160-001-000 AUDIT-BUDGET-ACCOUNTING	45,000	
001-7181-001-000 POSTAGE	2,000	
001-7183-001-000 DUES-MEETING EXPENSE	2,000	
001-7184-001-000 HOST FEE TRANSFER	15,000	
001-7185-001-000 PUBLISHING NOTICES	2,500	
001-7310-001-000 CO BOARD OFFICE SUPPLIES	1,000	
001-7370-001-000 FLEET FUEL	110,000	
001-7410-001-000 OFFICE EQUIPMENT	500	
001-7590-001-000 LABOR NEGOTIATIONS	1,000	
001-7596-001-000 UNBUDGETED EMERGENCY EXPENSE	5,000	
001-7597-001-000 COUNTY HEARING OFFICER	1,000	
Total Expenditure	2,521,550	

002 COMPUTER SERVICES

Fiscal year thru period ending 12/31/2016

Description	Revision 2	Budget Approved
001-7111-002-000 EQUIPMENT MTCE	7,700	
001-7195-002-000 COMPUTER PROGRAMS	60,500	
001-7199-002-000 COMPUTER PROGRAM MTCE	89,162	
001-7420-002-000 COMPUTER EQUIP	25,000	
001-7590-002-000 UNBUDGETED EMERGENCY EX	15,000	

Total Expenditure	197,362	

Run date: 10/11/2016 @ 14:35
Bus date: 12/01/2016

Coles County
Revenue and Expense Worksheet

Select...: A001-XXXX-XXX-XXX
E:\Carla\BUB Page 7

003 PLANNING COMMISSION

Fiscal year thru period ending 12/31/2016

Description	Revision	Budget
	2	Approved
001-7520-003-000 PLANNING COMMISSION OFF	101,242	
	-----	-----
Total Expenditure	101,242	
	-----	-----

Run date: 10/11/2016 @ 14:35
Bus date: 12/01/2016

Coles County
Revenue and Expense Worksheet

Select...: A001-XXXX-XXX-XXX
E:\Carla\BUB Page 8

004 PUBLIC SERVICES

Fiscal year thru period ending 12/31/2016

Description	Revision 2	Budget Approved
001-7048-004-000 CASA	18,000	
001-7072-004-000 SOIL CONSERVATION	22,500	
001-7511-004-000 COLES COUNTY EXTENSION	40,000	
001-7526-004-000 COLES COUNTY COUNCIL ON	10,000	
001-7590-004-000 ECONOMIC DEVELOPMENT	50,000	
	-----	-----
Total Expenditure	140,500	
	-----	-----

Run date: 10/11/2016 @ 14:35
Bus date: 12/01/2016

Coles County
Revenue and Expense Worksheet

Select.: A001-XXXX-XXX-XXX
E:\Carla\BUB Page 9

005 CONTINGENCIES

Fiscal year thru period ending 12/31/2016

Description	Revision 2	Budget Approved
001-7590-005-000 CO BOARD CONTINGENCY RE	72,750	
Total Expenditure	72,750	

006 TREASURER'S OFFICE

Fiscal year thru period ending 12/31/2016

Description	Revision 2	Budget Approved
001-7050-006-000 SALARIES	235,610	
001-7111-006-000 EQUIPMENT MAINTENANCE	3,800	
001-7150-006-000 TRAINING & TRAVEL	1,000	
001-7181-006-000 POSTAGE	16,000	
001-7183-006-000 ASSOCIATION DUES	400	
001-7185-006-000 PUBLISHING NOTICES	3,500	
001-7310-006-000 OFFICE SUPPLIES	4,000	
001-7319-006-000 TAX COLLECTION SUPPLIES	5,000	
001-7410-006-000 OFFICE EQUIPMENT	2,000	

Total Expenditure	271,310	

007 COUNTY CLERK'S OFFICE

Fiscal year thru period ending 12/31/2016

Description	Revision 2	Budget Approved
001-7031-007-000 ELECTION JUDGES-CLERKS	45,000	
001-7050-007-000 SALARIES	275,905	
001-7150-007-000 TRAVEL & TRAINING	3,000	
001-7176-007-000 RECORDING BIRTHS & DEAT	2,000	
001-7181-007-000 POSTAGE	28,000	
001-7183-007-000 ASSOCIATION DUES	500	
001-7185-007-000 PUBLISHING NOTICES	15,000	
001-7310-007-000 OFFICE SUPPLIES	5,000	
001-7312-007-000 ELECTION SUPPLIES-EXPEN	165,000	
001-7313-007-000 VOTER REGISTRATION EXP	7,000	
001-7410-007-000 OFFICE EQUIPMENT	1,500	
001-7591-007-000 OTHER GENERAL EXPENSES	1,500	
Total Expenditure	549,405	

008 SECURITY

Fiscal year thru period ending 12/31/2016

Description	Revision 2	Budget Approved
001-7050-008-000 SALARIES	175,000	
001-7188-008-000 TRAINING	2,000	
001-7351-008-000 UNIFORMS & BADGES	4,100	
001-7440-008-000 OFFICE EQUIPMENT	200	
001-7441-008-000 SECURITY EQUIPMENT	2,000	
001-7590-008-000 MISCELLANEOUS	400	
	-----	-----
Total Expenditure	183,700	
	-----	-----

009 SHERIFF'S OFFICE

Fiscal year thru period ending 12/31/2016

Description	Revision 2	Budget Approved
001-7033-009-000 PER DIEM-MERIT COMMISSI	2,000	
001-7050-009-000 SALARIES	2,435,350	
001-7073-009-000 SALARY-SUPT OF SAFETY	2,500	
001-7111-009-000 EQUIPMENT MICE	6,400	
001-7112-009-000 FLEET MAINTENANCE	35,000	
001-7155-009-000 TRAVEL OUTSIDE COUNTY	10,000	
001-7165-009-000 MEDICAL EXPENSE	258,005	
001-7181-009-000 POSTAGE	2,500	
001-7183-009-000 ASSOCIATION DUES	1,000	
001-7186-009-000 INMATE MEALS	98,500	
001-7188-009-000 TRAINING	30,000	
001-7199-009-000 OTHER CONTRACTUAL	1,500	
001-7310-009-000 OFFICE SUPPLIES	12,500	
001-7350-009-000 RANGE SUPPLIES	6,000	
001-7353-009-000 SUPPLIES ISSUED TO INMA	500	
001-7370-009-000 FLEET FUEL	70,000	
001-7425-009-000 NON-EMERGENCY DISPATCH	74,850	
001-7426-009-000 911 CONTRACT FEE & SERV	19,000	
001-7430-009-000 AUTOMOBILES	60,000	
001-7440-009-000 OFFICE EQUIPMENT	2,000	
001-7441-009-000 POLICE EQUIPMENT	45,100	
001-7450-009-000 COMMUNICATION EQUIP	24,000	
Total Expenditure	3,196,705	

Run date: 10/11/2016 @ 14:35
Bus date: 12/01/2016

Coles County
Revenue and Expense Worksheet

Select...: A001-XXXX-XXX-XXX
E:\Carla\BUB Page 14

Fiscal year thru period ending 12/31/2016

010 CIRCUIT CLERK'S OFFICE

Description	Revision 2	Budget Approved
001-7050-010-000 SALARIES	327,835	
001-7111-010-000 EQUIPMENT MTCE	5,000	
001-7150-010-000 TRAVEL	5,500	
001-7181-010-000 POSTAGE	7,500	
001-7183-010-000 ASSOCIATON DUES	350	
001-7310-010-000 OFFICE SUPPLIES	17,000	
001-7410-010-000 OFFICE EQUIP	4,000	
	-----	-----
Total Expenditure	367,185	
	-----	-----

Run date: 10/11/2016 @ 14:35
 Bus date: 12/01/2016

Coles County
 Revenue and Expense Worksheet

Select...: A001-XXXX-XXX-XXX
 E:\Carla\BUB Page 15

Fiscal year thru period ending 12/31/2016

011 COURTS

Description	Revision 2	Budget Approved
001-7051-011-000 ADMINISTRATIVE ASSISTAN	30,855	
001-7055-011-000 COURT ADMINISTRATOR	41,000	
001-7071-011-000 COUNTY SHARE JUDGES SAL	2,500	
001-7111-011-000 EQUIPMENT MTCE	1,000	
001-7150-011-000 JUDGES TRAVEL AND EDUCA	4,500	
001-7171-011-000 JUROR FEES	23,000	
001-7181-011-000 POSTAGE	1,000	
001-7187-011-000 DIETING JURORS	1,500	
001-7190-011-000 INTERPRETING	3,000	
001-7310-011-000 OFFICE SUPPLIES	15,000	
001-7312-011-000 CHIEF JUDGES EXPENSES	715	
001-7410-011-000 OFFICE EQUIPMENT	2,000	
Total Expenditure	126,070	

Run date: 10/11/2016 @ 14:35
 Bus date: 12/01/2016

Coles County
 Revenue and Expense Worksheet

Select...: A001-XXXX-XXX-XXX
 E:\Carla\BUB Page 16

Fiscal year thru period ending 12/31/2016

012 STATES ATTORNEY'S OFFICE

Description	Revision 2	Budget Approved
001-7050-012-000 SALARIES-STAFF	584,500	
001-7051-012-000 SALARY-STATES ATTORNEY	166,508	
001-7111-012-000 EQUIPMENT MTCE	10,000	
001-7150-012-000 TRAVEL EXPENSE	3,500	
001-7151-012-000 CONVENTION EXPENSE	4,200	
001-7152-012-000 INVESTIGATION AUTO	750	
001-7153-012-000 BOOKS	11,000	
001-7159-012-000 CHECK DIVERSION EXPENSE	10,000	
001-7167-012-000 SPECIAL COURT REPORTER	3,000	
001-7172-012-000 VICTIM-WITNESS-COORDINA	1,000	
001-7173-012-000 FOREIGN WITNESS	2,000	
001-7174-012-000 FOREIGN SERVICES	100	
001-7181-012-000 POSTAGE	4,000	
001-7183-012-000 ASSOCIATION DUES	3,500	
001-7185-012-000 PUBLISHING NOTICES	750	
001-7198-012-000 APPELLATE ASSIST PROJEC	18,000	
001-7310-012-000 OFFICE SUPPLIES	14,000	
001-7410-012-000 OFFICE EQUIPMENT	1,500	
001-7590-012-000 MEDICAL-MENTAL EXPENSES	11,000	
Total Expenditure	849,308	

Run date: 10/11/2016 @ 14:35
Bus date: 12/01/2016

Coles County
Revenue and Expense Worksheet

Select...: A001-XXXX-XXX-XXX
E:\Carla\BUB Page 17

Fiscal year thru period ending 12/31/2016

013 REGIONAL SUPT OF SCHOOLS

Description	Revision 2	Budget Approved
001-7520-013-000 REGIONAL EDUCATIONAL OF	87,915	
Total Expenditure	87,915	

Run date: 10/11/2016 @ 14:35
 Bus date: 12/01/2016

Coles County
 Revenue and Expense Worksheet

Select... A001-XXXX-XXX-XXX
 E:\Carla\BUB Page 18

Fiscal year thru period ending 12/31/2016

014 BUILDING & GROUNDS

Description	Revision 2	Budget Approved
001-7050-014-000 BUILDING & GROUNDS SALA	171,770	
001-7054-014-000 OVERTIME-CALL BACK PAY	2,000	
001-7111-014-000 EQUIPMENT MAINTENANCE	31,000	
001-7112-014-000 EQUIPMENT REPAIR	23,000	
001-7115-014-000 GENERAL MTCE-COURT HOUS	14,000	
001-7116-014-000 GENERAL MTCE-JAIL	23,000	
001-7117-014-000 GENERAL MTCE-ANIMAL SHE	1,000	
001-7141-014-000 TELEPHONE	97,000	
001-7142-014-000 FUEL & LIGHTS-COURT HOU	40,000	
001-7143-014-000 FUEL & LIGHTS-JAIL	56,538	
001-7144-014-000 FUEL-LIGHTS-ANIMAL SHEL	7,500	
001-7148-014-000 WATER-COURTHOUSE & JAIL	50,000	
001-7150-014-000 TRAVEL	1,000	
001-7340-014-000 BUILDING SUPPLIES	24,000	
001-7440-014-000 VEHICLE PURCHASE	2,000	
001-7460-014-000 BUILDING EQUIPMENT	3,000	
001-7490-014-000 IMPROVEMENT-LAND-BLDGS	80,000	
Total Expenditure	626,808	

Run date: 10/11/2016 @ 14:35
 Bus date: 12/01/2016

Coles County
 Revenue and Expense Worksheet

Select...: A001-XXXX-XXX-XXX
 E:\Carla\BUB Page 19

Fiscal year thru period ending 12/31/2016

015 SUPERVISOR OF ASSESSMENTS

Description	Revision 2	Budget Approved
001-7034-015-000 BOARD OF REVIEW SALARIE	12,000	
001-7050-015-000 SALARIES	190,645	
001-7055-015-000 INDUSTRIAL APPRAISAL	40,000	
001-7111-015-000 EQUIPMENT MTCE	5,000	
001-7150-015-000 SA TRAVEL & TRAINING	7,000	
001-7181-015-000 POSTAGE	20,000	
001-7183-015-000 ASSOCIATION DUES	1,000	
001-7185-015-000 PUBLISHING NOTICES	25,000	
001-7188-015-000 BOR TRAVEL & TRAINING	3,000	
001-7197-015-000 BOARD OF REVIEW EXPENSE	800	
001-7199-015-000 SUBSCRIPTIONS & LICENS	5,000	
001-7310-015-000 OFFICE SUPPLIES	7,000	
001-7410-015-000 OFFICE EQUIPMENT	2,000	
Total Expenditure	318,445	

Run date: 10/11/2016 @ 14:35
Bus date: 12/01/2016

Coles County
Revenue and Expense Worksheet

Select...: A001-XXXX-XXX-XXX
E:\Carla\BUB Page 20

Fiscal year thru period ending 12/31/2016

016 EMERGENCY SERVICE-DISASTER AGN

Description	Revision 2	Budget Approved
001-7050-016-000 SALARY-DIRECTOR	25,910	
001-7128-016-000 TELETYPE	576	
001-7149-016-000 COMMUNICATIONS	6,500	
001-7150-016-000 TRAINING	1,200	
001-7181-016-000 POSTAGE	10	
001-7310-016-000 OFFICE SUPPLIES	1,000	
001-7370-016-000 RESCUE TRUCK-VEHICLE TR	1,500	
001-7411-016-000 SAFETY EQUIPMENT	1,200	
Total Expenditure	37,896	

Run date: 10/11/2016 @ 14:35
Bus date: 12/01/2016

Coles County
Revenue and Expense Worksheet

Select...: A001-XXXX-XXX-XXX
E:\Carla\BUB Page 21

Fiscal year thru period ending 12/31/2016

017 JURY COMMISSION

Description	Revision 2	Budget Approved
001-7032-017-000 COMMISSIONERS PER DIEM	1,300	
001-7050-017-000 JURY COMMISSION CLERK	26,780	
001-7111-017-000 EQUIPMENT MTCE	1,200	
001-7181-017-000 POSTAGE	3,500	
001-7310-017-000 OFFICE SUPPLIES	2,000	
	-----	-----
Total Expenditure	34,780	
	-----	-----

Run date: 10/11/2016 @ 14:35
Bus date: 12/01/2016

Coles County
Revenue and Expense Worksheet

Select... A001-XXXX-XXX-XXX
E:\Carla\BUB Page 22

Fiscal year thru period ending 12/31/2016

018 COUNTY CORONER

Description	Revision 2	Budget Approved
001-7050-018-000 SALARIES-CORONER	61,835	
001-7111-018-000 EQUIPMENT MTCE	200	
001-7150-018-000 TRAINING-TRAVEL	4,000	
001-7155-018-000 MILEAGE-REIMBURSEMENT	3,000	
001-7164-018-000 AUTOPSIES-RELATED MEDIC	50,000	
001-7172-018-000 CORONER-JUROR FEES	200	
001-7183-018-000 ASSOCIATION DUES	700	
001-7190-018-000 CONTRACTED TRANSPORTATI	18,000	
001-7195-018-000 STENOGRAPHER FEES	300	
001-7315-018-000 UNCLAIMED REMAINS	2,000	
001-7410-018-000 OFFICE EQUIPMENT	1,000	
001-7411-018-000 CORONERS EQUIPMENT	9,000	
Total Expenditure	150,235	

Run date: 10/11/2016 @ 14:35
 Bus date: 12/01/2016

Coles County
 Revenue and Expense Worksheet

Select...: A001-XXXX-XXX-XXX
 E:\Carla\BUB Page 23

Fiscal year thru period ending 12/31/2016

019 PROBATION OFFICE

Description	Revision 2	Budget Approved
001-7050-019-000 SALARIES	901,032	
001-7057-019-000 DIRECTOR OF PROB & CRT	75,000	
001-7111-019-000 EQUIPMENT MTCE	2,000	
001-7144-019-000 SEX OFFENDER EVAL/TREAT	5,000	
001-7150-019-000 TRAVEL & TRAINING	18,000	
001-7165-019-000 GPS/ELECTRONIC MONITORI	1,000	
001-7181-019-000 POSTAGE	2,000	
001-7186-019-000 JUVENILE DETENTION EXPE	56,500	
001-7310-019-000 OFFICE SUPPLIES	5,000	
001-7331-019-000 DRUG SCREENS	15,000	
001-7333-019-000 PRETRIAL-COURT SERVICES	13,000	
001-7425-019-000 NON-EMERGENCY DISPATCH	5,838	
Total Expenditure	1,099,370	

Run date: 10/11/2016 @ 14:35
Bus date: 12/01/2016

Coles County
Revenue and Expense Worksheet

Select...: A001-XXXX-XXX-XXX
E:\Carla\BUB Page 24

Fiscal year thru period ending 12/31/2016

020 PUBLIC DEFENDER

Description	Revision 2	Budget Approved
001-7051-020-000 SECRETARY	37,495	
001-7058-020-000 SALARY-PUBLIC DEFENDER	149,850	
001-7059-020-000 ASSIST PUBLIC DEFENDERS	191,855	
001-7196-020-000 EXPENSES	79,825	
001-7410-020-000 OFFICE EQUIPMENT	950	
001-7590-020-000 COURT APPOINTED COUNSEL	27,000	
Total Expenditure	486,975	

Run date: 10/11/2016 @ 14:35
Bus date: 12/01/2016

Coles County
Revenue and Expense Worksheet

Select...: A001-XXXX-XXX-XXX
E:\Carla\SUB Page 25

Fiscal year thru period ending 12/31/2016

021 PUBLIC HEALTH & SAFETY

Description	Revision 2	Budget Approved
001-7500-021-000 TRANS TO PUBLIC HEALTH	210,000	
	-----	-----
Total Expenditure	210,000	
	-----	-----

Run date: 10/11/2016 @ 14:35
 Bus date: 12/01/2016

Coles County
 Revenue and Expense Worksheet

Select...: A001-XXXX-XXX-XXX
 E:\Carla\BUB Page 26

Fiscal year thru period ending 12/31/2016

022 ANIMAL CONTROLD

Description	Revision 2	Budget Approved
001-7050-022-000 SALARIES	199,900	
001-7061-022-000 ADMINISTRATIVE SALARY	12,000	
001-7117-022-000 BUILDING MAINTENANCE	13,000	
001-7121-022-000 EQUIPMENT RENTAL	3,000	
001-7144-022-000 PROPANE	6,000	
001-7188-022-000 TRAINING	3,500	
001-7191-022-000 DISPOSAL SERVICE	1,100	
001-7310-022-000 OFFICE SUPPLIES	6,500	
001-7340-022-000 CLEANING SUPPLIES	8,500	
001-7370-022-000 GAS FOR VAN & REPAIR	8,500	
001-7381-022-000 MEDICINE	20,000	
001-7382-022-000 DONATION-EXPENSES	30,000	
001-7410-022-000 EQUIPMENT	2,500	
001-7560-022-000 CERTIFICATIONS	1,000	
001-7570-022-000 REFUNDS	5,000	
001-7590-022-000 MISCELLANEOUS	4,000	
Total Expenditure	324,500	

Run date: 10/11/2016 @ 14:35
Bus date: 12/01/2016

Coles County
Revenue and Expense Worksheet

Select...: A001-XXXX-XXX-XXX
E:\Carla\BUB Page 27

Fiscal year thru period ending 12/31/2016

029 SHERIFFS RESTRICTED ACCOUNTS

Description	Revision 2	Budget Approved
001-7110-029-000 SHF DRUG PREVENTION	14,000	
001-7113-029-000 SHF K-9 EXPENSE	27,900	
001-7213-029-000 SHF CRIME PREVENTION	5,800	
001-7224-029-000 SHF INMATE TELEPHONE PR	74,000	
001-7249-029-000 SEX OFFENDER REGISTRATI	580	
001-7410-029-000 SHF DUI EQUIPMENT	35,000	

Total Expenditure	157,280	

Run date: 10/11/2016 @ 14:35
Bus date: 12/01/2016

Coles County
Revenue and Expense Worksheet

Select...: A001-XXXX-XXX-XXX
E:\Carla\BUB Page 28

Fiscal year thru period ending 12/31/2016

030 99 ALTERNATIVE BOND FUND

Description	Revision 2	Budget Approved
001-7510-030-000 2010 PROJECT BOND TRANS	155,655	
	-----	-----
Total Expenditure	155,655	
	-----	-----

Run date: 10/11/2016 @ 14:35
Bus date: 12/01/2016

Coles County
Revenue and Expense Worksheet

Select...: A001-XXXX-XXX-XXX
E:\Carla\BUB Page 29

Fiscal year thru period ending 12/31/2016

031 CHILD SUPPORT MTCE

Description	Revision 2	Budget Approved
001-7051-031-000 SALARIES-CHILD SUPPORT	29,235	
001-7411-031-000 OFFICE EQUIP	6,000	
Total Expenditure	35,235	

Run date: 10/11/2016 @ 14:35
Bus date: 12/01/2016

Coles County
Revenue and Expense Worksheet

Select...: A001-XXXX-XXX-XXX
E:\Carla\BUB Page 30

Fiscal year thru period ending 12/31/2016

035 RECORD STORAGE

Description	Revision 2	Budget Approved
001-7051-035-000 SALARIES	5,000	
001-7410-035-000 EXPENSES	140,000	
	-----	-----
Total Expenditure	145,000	
	-----	-----

Run date: 10/11/2016 @ 14:35
Bus date: 12/01/2016

Coles County
Revenue and Expense Worksheet

Select...: A001-XXXX-XXX-XXX
E:\Carla\BUB Page 31

Fiscal year thru period ending 12/31/2016

036 VITAL RECORDS AUTOMATION

Description	Revision 2	Budget Approved
001-7051-036-000 SALARIES	2,000	
001-7310-036-000 SUPPLIES	6,000	
001-7410-036-000 EXPENSES	6,000	
Total Expenditure	14,000	

Run date: 10/11/2016 @ 14:35
Bus date: 12/01/2016

Coles County
Revenue and Expense Worksheet

Select...: A001-XXXX-XXX-XXX
E:\Carla\BUB Page 32

Fiscal year thru period ending 12/31/2016

037 DOCUMENT STORAGE

Description	Revision 2	Budget Approved
001-7051-037-000 SALARIES - DOCUMENT STO	38,165	
001-7411-037-000 OTHER EXPENSES-DOCUMENT	120,000	
Total Expenditure	158,165	

Run date: 10/11/2016 @ 14:35
Bus date: 12/01/2016

Coles County
Revenue and Expense Worksheet

Select...: A001-XXXX-XXX-XXX
E:\Carla\BUB Page 33

Fiscal year thru period ending 12/31/2016

039 COURT AUTOMATION

Description	Revision 2	Budget Approved
001-7051-039-000 SALARIES-COURT AUTOMATI	32,435	
001-7411-039-000 OTHER EXPENSES-COURT AU	150,000	
Total Expenditure	182,435	

Run date: 10/11/2016 @ 14:35
Bus date: 12/01/2016

Coles County
Revenue and Expense Worksheet

Select...: A001-XXXX-XXX-XXX
E:\Carla\BUB Page 34

Fiscal year thru period ending 12/31/2016

046 TREASURERS EQUIPMENT

Description	Revision 2	Budget Approved
001-7310-046-000 EXPENSES	7,000	
001-7410-046-000 TREASURERS EQUIPMENT	25,000	
	-----	-----
Total Expenditure	32,000	
	-----	-----

Run date: 10/11/2016 @ 14:35
Bus date: 12/01/2016

Coles County
Revenue and Expense Worksheet

Select...: A001-XXXX-XXX-XXX
E:\Carla\BUB Page 35

Fiscal year thru period ending 12/31/2016

047 CIR CLK OP & ADMIN

Description	Revision 2	Budget Approved
001-7050-047-000 SALARIES	6,940	
001-7411-047-000 OTHER EXPENSES	200	
Total Expenditure	7,140	

Run date: 10/11/2016 @ 14:35
Bus date: 12/01/2016

Coles County
Revenue and Expense Worksheet

Select...: A001-XXXX-XXX-XXX
E:\Carla\BUB Page 36

Fiscal year thru period ending 12/31/2016

049 ARRA SEX OFFENDER GRANT

Description	Revision 2	Budget Approved
001-7050-049-000 SALARY	51,052	
001-7165-049-000 TREATMENT	13,667	
	-----	-----
Total Expenditure	64,719	
	-----	-----

Fiscal year thru period ending 12/31/2016

024 PUBLIC HEALTH

Description	Revision 2	Budget Approved
028-4023-024-000 PUBLIC HEALTH-LICENSE	317,600	
028-4081-024-000 INTEREST	200	
028-4086-024-000 PUBLIC HEALTH GRANT	559,387	
028-4087-024-000 REIMB-NURSES SALARY	85,400	
028-4090-024-000 TRANS FROM CO GEN FUND	218,000	
Total Revenue	1,180,587	
028-7050-024-000 SALARIES-PUBLIC HEALTH	800,000	
028-7052-024-000 CO GENERAL ADMIN REIMB	17,200	
028-7121-024-000 COPYING	6,500	
028-7123-024-000 RENT	58,320	
028-7150-024-000 TRAVEL	23,500	
028-7310-024-000 SUPPLIES	5,000	
028-7410-024-000 EQUIPMENT	14,000	
028-7551-024-000 PUBLIC EDUCATION	1,000	
028-7553-024-000 PROGRAM EXPENSE	130,000	
028-7554-024-000 INSECT CONTROL	14,000	
Total Expenditure	1,069,520	
Excess Revenue over (under) Expenditures	111,067	

Run date: 10/11/2016 @ 14:30
 Bus date: 12/01/2016

Coles County
 Revenue and Expense Worksheet

Select...: AXXX-XXXX-XXX-XXX
 E:\Carla\BUB Page 2

Fiscal year thru period ending 12/31/2016

025 REGIONAL PLANNING COMMISSION

Description	Revision 2	Budget Approved
035-4011-025-000 DOUGLAS COUNTY	3,000	
035-4014-025-000 MOULTRIE COUNTY	15,500	
035-4017-025-000 CITY OF ARCOLA	1,000	
035-4024-025-000 TIPPING FEE	7,000	
035-4026-025-000 CHARLESTON	7,000	
035-4028-025-000 CITY OF NEOGA	45,000	
035-4030-025-000 ASHMORE	2,000	
035-4031-025-000 HUMBOLDT	1,500	
035-4032-025-000 LERNA	1,500	
035-4033-025-000 MATTOON	45,000	
035-4034-025-000 OAKLAND	10,500	
035-4035-025-000 VILLAGE OF TOLEDO	5,000	
035-4036-025-000 EF AND S	468	
035-4038-025-000 SALARIES-REIMBURSEMENT	101,242	
035-4047-025-000 COUNTY GIS SERVICES	30,000	
035-4051-025-000 CITY OF SULLIVAN	7,000	
035-4053-025-000 SHELBY COUNTY	30,000	
035-4055-025-000 COLES COUNTY FARM BUREAU	7,700	
035-4081-025-000 INTEREST	500	
035-4085-025-000 MISCELLANEOUS	15,000	
035-4086-025-000 COUNCIL ON AGING	9,750	
035-4087-025-000 CLARK COUNTY	6,000	
035-4103-025-000 ENVIRONMENTAL REVIEW	500	

Fiscal year thru period ending 12/31/2016

025 REGIONAL PLANNING COMMISSION

Description	Revision 2	Budget Approved
035-4106-025-000 CITY OF CASEY	1,000	
035-4109-025-000 GIS PROJECTS	27,000	
035-4113-025-000 5 COUNTY TRANSPORTATION	11,000	
<hr/>		
Total Revenue	391,160	
<hr/>		
035-7050-025-000 SALARIES	240,106	
035-7052-025-000 CO GENERAL ADMIN REIMB	10,000	
035-7111-025-000 EQUIP EXPENSE	11,000	
035-7130-025-000 BONDING	70	
035-7150-025-000 TRAVEL	16,000	
035-7151-025-000 WORKSHOP & CONFERENCE	6,500	
035-7181-025-000 POSTAGE	2,000	
035-7183-025-000 SUBS-DUES-PUBS	7,500	
035-7184-025-000 HOUSING EXPENDITURES	21,000	
035-7187-025-000 OFFICE DEVELOPMENT	500	
035-7189-025-000 PRINTING	12,000	
035-7199-025-000 CONTRACTUAL LABOR	30,000	
035-7310-025-000 SUPPLIES	2,800	
035-7314-025-000 TELEPHONE	3,900	
035-7590-025-000 MISCELLANEOUS	12,500	
<hr/>		
Total Expenditure	375,876	
<hr/>		
Excess Revenue over (under) Expenditures	15,284	
<hr/>		

Coles County
 Revenue and Expense Worksheet

Fiscal year thru period ending 12/31/2016

050 HIGHWAY

Description	Revision 2	Budget Approved
002-4001-050-000 PROPERTY TAX LEVY	516,892	
002-4003-050-000 MOBILE HOME TAX	800	
002-4004-050-000 REPLACEMENT TAX	75,000	
002-4081-050-000 INTEREST ON INVESTMENTS	800	
002-4089-050-000 MISCELLANEOUS	26,000	
Total Revenue	619,492	
002-7050-050-000 SALARIES	189,920	
002-7052-050-000 CO GENERAL ADMIN REIMB	15,000	
002-7085-050-000 EMPLOYEE HEALTH INSURAN	35,000	
002-7150-050-000 MILEAGE AND EXPENSE	4,500	
002-7181-050-000 POSTAGE	500	
002-7183-050-000 ASSOCIATION DUES	900	
002-7210-050-000 ADVERTISING & RIGHT OF	1,200	
002-7211-050-000 TITLE SEARCHES	3,500	
002-7212-050-000 ROW ACQUISITION	12,000	
002-7220-050-000 MAINTENANCE OF ROADS	140,000	
002-7230-050-000 CONSTRUCTION OF ROADS	150,000	
002-7240-050-000 WARNING, REG REF & GUIDE	10,000	
002-7310-050-000 OFFICE SUPPLIES	2,000	
002-7360-050-000 ENGINEERING SUPPLIES	4,000	
002-7370-050-000 VEHICLE EXPENSE	16,000	

Run date: 10/11/2016 @ 14:30
 Bus date: 12/01/2016

Coles County
 Revenue and Expense Worksheet

Select...: AXXX-XXXX-XXX-XXX
 E:\Carla\BUB Page 5

Fiscal year thru period ending 12/31/2016

050 HIGHWAY

Description	Revision 2	Budget Approved
002-7410-050-000 OFFICE EQUIPMENT	3,000	
002-7430-050-000 MAINTENANCE EQUIPMENT	10,000	
002-7431-050-000 HWY-UTILITIES	2,500	
002-7432-050-000 CELLULAR TELEPHONE EXPE	3,000	
002-7450-050-000 GIS & GPS EXPENSE	3,000	
002-7470-050-000 SURVEY EQUIPMENT	8,000	

Total Expenditure	614,020	

Excess Revenue over (under) Expenditures	5,472	
	=====	

Run date: 10/11/2016 @ 14:30
 Bus date: 12/01/2016

Coles County
 Revenue and Expense Worksheet

Select...: AXXX-XXXX-XXX-XXX
 E:\Carla\BUB Page 6

Fiscal year thru period ending 12/31/2016

051 CONTRUCTION OF BRIDGES

Description	Revision 2	Budget Approved
003-4001-051-000 PROPERTY TAX LEVY	295,341	
003-4003-051-000 MOBILE HOME TAX	500	
003-4004-051-000 REPLACEMENT TAX	37,000	
003-4081-051-000 INTEREST ON INVESTMENTS	500	
003-4089-051-000 MISCELLANEOUS	10,000	
<hr/>		
Total Revenue	343,341	
<hr/>		
003-7288-051-000 TOWNSHIP BRIDGES	225,000	
003-7311-051-000 COUNTY BRIDGES	650,000	
<hr/>		
Total Expenditure	875,000	
<hr/>		
Excess Revenue over (under) Expenditures	(531,659)	
<hr/>		

Run date: 10/11/2016 @ 14:30
 Bus date: 12/01/2016

Coles County
 Revenue and Expense Worksheet

Select...: AXXX-XXXX-XXX-XXX
 E:\Carla\BUB Page 7

Fiscal year thru period ending 12/31/2016

052 HIGHWAY MATCHING

Description	Revision 2	Budget Approved
004-4001-052-000 PROPERTY TAX LEVY	295,341	
004-4003-052-000 MOBILE HOME TAX	500	
004-4004-052-000 REPLACEMENT TAX	35,000	
004-4015-052-000 TRUCK ACCESS RTE PROGRA	311,400	
004-4081-052-000 INTEREST ON INVESTMENTS	10,000	
004-4089-052-000 MISCELLANEOUS	10,000	
Total Revenue	662,241	
004-7239-052-000 CO HIGHWAY MICE	750,000	
004-7250-052-000 TRUCK ACCESS RTE PROGRA	311,400	
Total Expenditure	1,061,400	
Excess Revenue over (under) Expenditures	(399,159)	

Run date: 10/11/2016 @ 14:30
 Bus date: 12/01/2016

Coles County
 Revenue and Expense Worksheet

Select...: AXXX-XXXX-XXX-XXX
 E:\Carla\BUB Page 8

Fiscal year thru period ending 12/31/2016

055 GENERAL LONG TERM DEBT ACCOUNT

Description	Revision 2	Budget Approved
014-4014-055-000 TRANSFER-COUNTY GENERAL	155,655	
Total Revenue	155,655	
014-7087-055-000 2010 INTEREST PAYMENTS	25,655	
014-7088-055-000 2010 PRINCIPLE PAYMENTS	130,000	
Total Expenditure	155,655	
Excess Revenue over (under) Expenditures	0	

Run date: 10/11/2016 @ 14:30
 Bus date: 12/01/2016

Coles County
 Revenue and Expense Worksheet

Select...: AXXX-XXXX-XXX-XXX
 E:\Carla\BUB Page 9

Fiscal year thru period ending 12/31/2016

056 GIS-GEOGRAPHIC INFORMATION SYS

Description	Revision 2	Budget Approved
015-4006-056-000 GIS INCOME	1,800	
015-4038-056-000 RECORDING FEES	138,300	
015-4081-056-000 INTEREST	20	
<hr/>		
Total Revenue	140,120	
<hr/>		
015-7050-056-000 SALARY	33,660	
015-7052-056-000 ADMINISTRATIVE REIMB	6,500	
015-7085-056-000 HEALTH INSURANCE REIMB	5,500	
015-7111-056-000 HARDWARE MICE	2,200	
015-7150-056-000 WORKSHOP/TRAVEL	2,000	
015-7155-056-000 CONTRACTUAL	7,000	
015-7176-056-000 PROFESSIONAL SERVICES	30,000	
015-7310-056-000 OFFICE SUPPLIES	2,000	
015-7410-056-000 COMPUTER HARDWARE	8,000	
015-7420-056-000 COMPUTER SOFTWARE	40,000	
<hr/>		
Total Expenditure	136,860	
<hr/>		
Excess Revenue over (under) Expenditures	3,260	
<hr/>		

Run date: 10/11/2016 @ 14:30
 Bus date: 12/01/2016

Coles County
 Revenue and Expense Worksheet

Select...: AXXX-XXXX-XXX-XXX
 E:\Carla\BUB Page 10

Fiscal year thru period ending 12/31/2016

057 PROBATION SERVICE FEES

Description	Revision 2	Budget Approved
034-4070-057-000 PROBATION FEES	200,000	
034-4072-057-000 HOME CONFINEMENT	2,500	
034-4074-057-000 DRUG COURT	15,000	
034-4081-057-000 INTEREST	500	
	-----	-----
Total Revenue	218,000	
	-----	-----
034-7073-057-000 STATE SHORTFALL	66,106	
034-7111-057-000 ELECTRONIC MONITORING	6,500	
034-7174-057-000 DRUG COURT	15,000	
034-7188-057-000 TRAINING	20,000	
034-7199-057-000 CONTRACTUAL	35,000	
034-7412-057-000 PROBATION SERVICE EQUIP	65,000	
	-----	-----
Total Expenditure	207,606	
	-----	-----
Excess Revenue over (under) Expenditures	10,394	
	=====	=====

Run date: 10/11/2016 @ 14:30
 Bus date: 12/01/2016

Coles County
 Revenue and Expense Worksheet

Select...: AXXX-XXXX-XXX-XXX
 E:\Carla\BUB Page 11

Fiscal year thru period ending 12/31/2016

059 T B

Description	Revision 2	Budget Approved
021-4001-059-000 PROPERTY TAX LEVY	112,855	
021-4003-059-000 MOBILE HOME TAX	220	
021-4081-059-000 INTEREST ON INVESTMENTS	200	
021-4089-059-000 MISCELLANEOUS	1,800	

Total Revenue	115,075	

021-7032-059-000 BOARD MEETING EXPENSES	600	
021-7052-059-000 CO GENERAL ADMIN REIMB	1,330	
021-7123-059-000 RENT	4,700	
021-7165-059-000 CARE OF PATIENTS	16,000	
021-7183-059-000 ASSOCIATION DUES	130	
021-7187-059-000 NURSE-CONTRACTUAL	85,400	
021-7188-059-000 NURSE/PATIENT EDUCATION	265	
021-7196-059-000 OFFICE EXPENSE	4,000	
021-7370-059-000 NURSES CAR EXPENSE	1,000	
021-7410-059-000 OFFICE EQUIPMENT	1,650	

Total Expenditure	115,075	

Excess Revenue over (under) Expenditures	0	
=====		

Coles County
 Revenue and Expense Worksheet

Fiscal year thru period ending 12/31/2016

060 RETIREMENT

Description	Revision 2	Budget Approved
020-4001-060-000 PROPERTY TAX LEVY	1,312,900	
020-4003-060-000 MOBILE HOME TAX	2,000	
020-4004-060-000 REPLACEMENT TAX	30,000	
020-4081-060-000 INTEREST ON INVESTMENTS	1,000	
020-4086-060-000 REIMB-OTHER DEPARTMENTS	94,000	
020-4088-060-000 FROM EMPLOYEE WAGES	480,500	
Total Revenue	1,920,400	
020-7091-060-000 RETIREMENT CONTRIBUTION	1,439,900	
020-7092-060-000 RETIREMENT CONTRIBUTION	480,500	
020-7093-060-000 ADDITIONAL ECO DEBT PAY	100,000	
Total Expenditure	2,020,400	
Excess Revenue over (under) Expenditures	(100,000)	

061 MENTAL HELATH

Description	Revision 2	Budget Approved
022-4001-061-000 PROPERTY TAX LEVY	975,000	
022-4003-061-000 MOBILE HOME TAX	1,400	
022-4004-061-000 REPLACEMENT TAX	65,850	
022-4081-061-000 INTEREST	3,000	
022-4089-061-000 OTHER RECEIPTS	100	
Total Revenue	1,045,350	
022-7050-061-000 SALARIES	126,450	
022-7052-061-000 CO GEN FUND ADMIN REIMB	7,000	
022-7141-061-000 TELEPHONE	3,000	
022-7150-061-000 TRAVEL	1,500	
022-7162-061-000 LEGAL & CONSULTANT	1,000	
022-7183-061-000 DUES & MEETINGS	6,000	
022-7310-061-000 OFFICE SUPPLIES	6,000	
022-7410-061-000 EQUIPMENT	3,000	
022-7501-061-000 COLES CO ASSN FOR RETAR	213,000	
022-7502-061-000 COLES CO MENTAL HEALTH	192,000	
022-7503-061-000 CEN EAST ALCOHOL-DRUG C	200,100	
022-7504-061-000 CAMP NEW HOPE	104,000	
022-7505-061-000 BIG BROS-BIG SIS OF COL	83,000	
022-7506-061-000 HOPE OF EAST CENTRAL IL	84,000	
022-7507-061-000 IL COALITION FOR COMMUN	12,000	

Run date: 10/11/2016 @ 14:30
 Bus date: 12/01/2016

Coles County
 Revenue and Expense Worksheet

Select...: AXXX-XXXX-XXX-XXX
 E:\Carla\BUB Page 14

Fiscal year thru period ending 12/31/2016

061 MENTAL HELATH

Description	Revision 2	Budget Approved
022-7508-061-000 CHARLESTON TRANSITIONAL	16,000	
022-7509-061-000 COLES COUNTY COUNCIL ON	3,000	
022-7590-061-000 CONTINGENCIES	10,000	

Total Expenditure	1,071,050	

Excess Revenue over (under) Expenditures	(25,700)	
=====		

Fiscal year thru period ending 12/31/2016

062 MENTAL HELATH

Description	Revision 2	Budget Approved
022-4080-062-000 COPYING	4,000	
022-4084-062-000 VENDING	100	
022-4085-062-000 RENT	310,000	
022-4089-062-000 OTHER RECEIPTS	100	

Total Revenue	314,200	

022-7052-062-000 CO GEN FUND ADMIN REIMB	12,250	
022-7074-062-000 SALARY-BLDG ADMINISTRAT	10,000	
022-7075-062-000 SALARY-MTCE	78,500	
022-7100-062-000 LOAN PAYMENT	84,000	
022-7111-062-000 REPAIRS	10,000	
022-7130-062-000 INSURANCE- (BLDG)	10,000	
022-7145-062-000 ELECTRICITY	17,500	
022-7146-062-000 GAS	12,000	
022-7148-062-000 WATER	1,750	
022-7150-062-000 VEHICLE OPERATIONS	1,000	
022-7184-062-000 COPYING	6,500	
022-7340-062-000 MAINTENANCE SUPPLIES (B	1,500	
022-7490-062-000 MAJOR PROJECTS	50,000	
022-7555-062-000 SNOW & TRASH REMOVAL	10,000	
022-7590-062-000 CONTINGENCIES	10,000	

Total Expenditure	315,000	

Excess Revenue over (under) Expenditures	(800)	

Run date: 10/11/2016 @ 14:30
 Bus date: 12/01/2016

Coles County
 Revenue and Expense Worksheet

Select...: AXXX-XXXX-XXX-XXX
 E:\Carla\BUB Page 16

Fiscal year thru period ending 12/31/2016

064 EMERGENCY TELEPHONE SYSTEMS

Description	Revision 2	Budget Approved
018-4006-064-000 SURCHARGE	409,452	
018-4007-064-000 WIRELESS SURCHARGE	259,200	
018-4081-064-000 INTEREST	6,516	
018-4085-064-000 RENT	1,500	
018-4086-064-000 NON EMERGENCY DISPATCH	392,252	
018-4087-064-000 SOFTWARE REIMBURSEMENT	77,755	
018-4089-064-000 MISCELLANEOUS	51,000	
018-4187-064-000 EMPLOYEE SHARE HTH INSU	26,113	
018-4200-064-000 MOULTRIE CO WIRELESS	74,664	
018-4205-064-000 MOULTRIE CONSOLIDATION	153,136	
Total Revenue	1,451,588	
018-7050-064-000 SALARIES	763,066	
018-7052-064-000 FRINGE EXPENSE	159,000	
018-7085-064-000 HEALTH INSURANCE	111,000	
018-7086-064-000 EMPLOYEE EXPENSE	7,500	
018-7111-064-000 EQUIPMENT MAINTENANCE	93,255	
018-7141-064-000 TELEPHONE	63,600	
018-7143-064-000 FUEL & LIGHTS	17,000	
018-7148-064-000 WATER	2,000	
018-7155-064-000 CONSULTANT FEES	7,800	
018-7181-064-000 POSTAGE	200	

25

Run date: 10/11/2016 @ 14:30
 Bus date: 12/01/2016

Coles County
 Revenue and Expense Worksheet

Select...: AXXX-XXXX-XXX-XXX
 E:\Carla\BUB Page 17

Fiscal year thru period ending 12/31/2016

064 EMERGENCY TELEPHONE SYSTEMS

Description	Revision 2	Budget Approved
018-7183-064-000 DUES & ASSOCIATE FEES	150	
018-7185-064-000 PUBLISHING & ADVERTISIN	300	
018-7188-064-000 TRAINING EDUCATION	10,000	
018-7205-064-000 MOULTRIE CONSOLIDATION	153,136	
018-7310-064-000 OFFICE SUPPLIES	6,000	
018-7410-064-000 OFFICE EQUIPMENT	20,000	
018-7460-064-000 BUILDING COST & MTCE	18,000	
018-7486-064-000 EQUIPMENT UPDGRADE GRAN	50,000	
018-7590-064-000 MISCELLANEOUS	9,000	
Total Expenditure	1,491,007	
Excess Revenue over (under) Expenditures	(39,419)	

Run date: 10/11/2016 @ 14:30
 Bus date: 12/01/2016

Coles County
 Revenue and Expense Worksheet

Select..: AXXX-XXXX-XXX-XXX
 E:\Carla\BUB Page 18

Fiscal year thru period ending 12/31/2016

065 LAW LIBRARY

Description	Revision 2	Budget Approved
025-4043-065-000 FEES FROM CIRCUIT CLERK	20,950	
025-4081-065-000 INTEREST-CO LAW LIBRARY	50	
025-4086-065-000 REIMB-OTHER DEPARTMENTS	13,000	

Total Revenue	34,000	

025-7179-065-000 LIBRARIAN EXPENSE	3,060	
025-7310-065-000 OFFICE SUPPLIES	500	
025-7311-065-000 BOOKS	30,500	

Total Expenditure	34,060	

Excess Revenue over (under) Expenditures	(60)	
=====		

Run date: 10/11/2016 @ 14:30
 Bus date: 12/01/2016

Coles County
 Revenue and Expense Worksheet

Select...: AXXX-XXXX-XXX-XXX
 E:\Carla\BUB Page 19

Fiscal year thru period ending 12/31/2016

066 SPECIAL

Description	Revision 2	Budget Approved
026-4002-066-000 LIABILITY-PROP TAX LEVY	230,000	
026-4007-066-000 SENIOR CITIZENS FUND	156,000	
026-4008-066-000 SOCIAL SECURITY-PROP TA	681,000	
026-4010-066-000 WORKMENS COMP-PROP TAX	120,000	
026-4081-066-000 INTEREST ON INVESTMENTS	500	

Total Revenue	1,187,500	

026-7090-066-000 UNEMPLOYMENT INSURANCE	10,000	
026-7091-066-000 WORKMENS COMP-INSURANCE	120,000	
026-7500-066-000 TRANSFERS	500	
026-7501-066-000 SENIOR CITIZEN ORGANIZA	156,000	
026-7502-066-000 LIABILITY	220,000	
026-7503-066-000 SOCIAL SECURITY	681,000	

Total Expenditure	1,187,500	

Excess Revenue over (under) Expenditures	0	
=====		

Run date: 10/11/2016 @ 14:30
 Bus date: 12/01/2016

Coles County
 Revenue and Expense Worksheet

Select...: AXXX-XXXX-XXX-XXX
 E:\Carla\BUB Page 20

Fiscal year thru period ending 12/31/2016

086 TIPPING FEE OFFICE

Description	Revision 2	Budget Approved
011-4021-086-000 REIMB FROM CITY	2,000	
011-4081-086-000 INTEREST	1,000	
011-4086-086-000 REIMB FROM TOWNSHIPS	21,000	
011-4087-086-000 HOST FEES	15,000	
Total Revenue	39,000	
011-7150-086-000 WORKSHOP/TRAVEL	500	
011-7153-086-000 EDUCATION MATERIALS	500	
011-7176-086-000 CONTRACTUAL-STAFF	7,000	
011-7385-086-000 ROLL-OFF PROGRAM	42,000	
011-7598-086-000 SPECIAL WASTE COLLECTIO	8,000	
011-7599-086-000 RECYCLING-GRANT/LOAN FU	8,000	
Total Expenditure	66,000	
Excess Revenue over (under) Expenditures	(27,000)	

State of Illinois)
)
County of Coles)

HOLIDAY CALENDAR FOR 2017

BE IT RESOLVED by the County Board of Coles County, Illinois that the following dates are designated as holidays for the year 2017:

Monday, January 2, 2017	New Year's Day (observed)
Monday, January 16, 2017	Martin Luther King, Jr. Day
Monday, February 13, 2017	Lincoln's Birthday (observed)
Monday, February 20, 2017	Presidents Day
Friday, April 14, 2017	Good Friday
Monday, May 29, 2017	Memorial Day
Tuesday, July 4, 2017	Independence Day
Monday, September 4, 2017	Labor Day
Monday, October 9, 2017	Columbus Day
Friday, November 10, 2017	Veterans Day (observed)
Thursday, November 23, 2017	Thanksgiving Day
Friday, November 24, 2017	Day following Thanksgiving Day
Monday, December 25, 2017	Christmas Day

DATED this ____ day of _____, 2016.

ATTEST:

_____ Clerk

RESOLUTION AUTHORIZING EXECUTION AND AMENDMENT OF DOWNSTATE OPERATING ASSISTANCE GRANT AGREEMENT

WHEREAS, the provision of public transportation service is essential to the people of Illinois; and

WHEREAS, the Downstate Public Transportation Act (30 ILCS 740/2-1 et seq.) ("Act") authorizes the State of Illinois, acting by and through the Illinois Department of Transportation, to provide grants and make funds available to assist in the development and operation of public transportation systems; and

WHEREAS, grants for said funds will impose certain obligations upon the recipient, including provision by it of the local share of funds necessary to cover costs not covered by funds provided under the Downstate Public Transportation Act.

NOW, THEREFORE, BE IT RESOLVED BY THE County Board OF THE County of Coles:

Section 1. That the County of Coles enter into a Downstate Public Transportation Operating Assistance Agreement ("Agreement") with the State of Illinois and amend such Agreement, if necessary, for fiscal year 2017 in order to obtain grant assistance under the provisions of the Act.

Section 2. That the Board Chair of the Coles County Board is hereby authorized and directed to execute the Agreement or its amendment(s) on behalf of the County of Coles for such assistance for fiscal year 2017.

Section 3. That the Board Chair of the County of Coles is hereby authorized to provide such information and file such documents as may be required to perform the Agreement and to request and receive the grant funding for fiscal year 2017.

Section 4. That while participating in said operating assistance program the (name of grantee) shall provide all required local matching funds.

PRESENTED and ADOPTED this 9th day of November, 2016

(Signature of Authorized Official)
County Board Chair

(Title)

(Attest)

(Date)

PART TWO ATTACHMENT 3

RESOLUTION AUTHORIZING EXECUTION AND AMENDMENT OF DOWNSTATE OPERATING ASSISTANCE GRANT AGREEMENT

WHEREAS, the provision of public transit service is essential to the transportation of persons in the non-urbanized area; and

WHEREAS, 49 U.S.C. § 5311 ("Section 5311"), makes funds available to the State of Illinois to help offset certain operating deficits and administrative expenses of a system providing public transit service in non-urbanized areas; and

WHEREAS, the State of Illinois, acting by and through the Illinois Department of Transportation, is authorized by 30 ILCS 740/3-1 et seq. to provide the Section 5311 grant; and

WHEREAS, grants for said funds will impose certain obligations upon the recipient, including the provision by it of the local share of funds necessary to cover costs not covered by funds provided under Section 5311.

NOW, THEREFORE, BE IT RESOLVED BY THE GOVERNING BOARD OF THE Coles County:

Section 1. That an application be made to the Office of Intermodal Project Implementation, Department of Transportation, State of Illinois, for a financial assistance grant under Section 5311 for fiscal year 20¹⁷, for the purpose of off-setting a portion of the Public Transportation Program operating deficits of Coles County.

Section 2. That while participating in said operating assistance program the Coles County will provide all required local matching funds.

Section 3. That Stan Metzger of the County of Coles is hereby authorized and directed to execute and file on behalf of the Coles County such application.

Section 4. That the Stan Metzger of the County of Coles is authorized to furnish such additional information as may be required by the Office of Intermodal Project Implementation and the Federal Transit Administration in connection with the aforesaid application for said grant.

Section 5. That Stan Metzger of the County of Coles is hereby authorized and directed to execute and file on behalf of the Coles County a Section 5311 Grant Agreement ("Agreement") with the Illinois Department of Transportation, and amend such Agreement, if necessary, in order to obtain grant assistance under the provisions of Section 5311 for fiscal year 20¹⁷.

Section 6. That Stan Metzger of the County of Coles is hereby authorized to provide such information and to file such documents as may be required to perform the Agreement and to receive the grant for fiscal year 20¹⁷.

PRESENTED and ADOPTED this 9th day of November, 20 17

(Signature of Authorized Official)

(Attest)

(Title) (Date)

State of Illinois
GRANT AGREEMENT FISCAL YEAR 2017 / 3 28 16
Page 51 of 67

An Intergovernmental Agreement for

**Structure Replacement Project
Section 16-01137-00-BR
Structure No: 015-3113
TR 137B in Ashmore Township**

THIS AGREEMENT is entered into between the County of Coles, Illinois and the Township of Ashmore, in Coles County, Illinois on the 9th day of November, 2016. The parties hereby state and agree as follows:

A. Purpose and Objectives:

Coles County and Ashmore Township find it to be in the public's best interest to improve a structure on TR 137B in Ashmore Township.

B. Powers:

1. The parties are empowered by the Highway Code to provide Construction and Maintenance for County and Township drainage structures, 605 ILCS 5/5-501.
2. The parties are empowered by the Intergovernmental Agreement Act (5 ILCS 220/3), and the Illinois Constitution (Ill. Const. 1970, Art. VII, Sec. 10) to enter into this Agreement.

C. Rights and Responsibilities:

1. The cost for the construction and other expenses of said project will be divided accordingly:
 - a. Ashmore Township will contribute 10 % of the engineering and construction costs of the project. Ashmore Township will contribute 100% of the right of way costs.
 - b. Coles County will contribute 10 % of the engineering and construction costs of the project.
 - c. Township Bridge Funds will contribute 80% of the engineering and construction costs of the project.
 - d. Coles County will perform all construction engineering duties required for this project.
2. The parties hereby agree to take any official action necessary to accomplish their respective obligations, as set forth in this Agreement.
3. This writing constitutes the entire agreement of the parties and no other representations related to this Agreement, written or oral, prior to or concurrent with this writing, shall have any effect.
4. This Agreement shall be effective as the first date written above.

5. This Agreement shall be binding upon and insure to the benefit of the parties hereto, their successors and assignees.

IN WITNESS WHEREOF, the parties given below have executed this Agreement.

Coles County, Illinois;

Date: _____

By: _____
County Engineer

Date: _____

By: _____
County Board Chair

Ashmore Township, Illinois;

Date: 10-11-16

By: [Signature]
Township Road Commissioner

Date: 10-11-16

By: [Signature]
Township Supervisor

Municipality Coles Co Highway Department	L O C A L A G E N C Y	Preliminary Engineering Services Agreement For Motor Fuel Tax Funds	C O N S U L T A N T	Name ESI Consultants, Ltd.
Township Ashmore				Address 753 Windsor Road
County Coles				City Charleston
Section 16-01137-00-BR				State IL

THIS AGREEMENT is made and entered into this _____ day of _____, _____ between the above Local Agency (LA) and Consultant (ENGINEER) and covers certain professional engineering services in connection with the improvement of the above SECTION. Motor Fuel Tax Funds, allotted to the LA by the State of Illinois under the general supervision of the State Department of Transportation, hereinafter called the "DEPARTMENT", will be used entirely or in part to finance ENGINEERING services as described under AGREEMENT PROVISIONS.

Section Description

Name TR 137

Route TR 137 Length 0.11 Mi. 600.00 FT (Structure No. 015-3113)

Termini Approximately 325' east of IL 49 extending eastward 600'.

Description:

Surveying, Foundation borings, Phase 1 and 2 engineering for the replacement of structure and associated roadway.

Agreement Provisions

The Engineer Agrees,

1. To perform or be responsible for the performance of the following engineering services for the LA, in connection with the proposed improvements herein before described, and checked below:
 - a. Make such detailed surveys as are necessary for the preparation of detailed roadway plans
 - b. Make stream and flood plain hydraulic surveys and gather high water data, and flood histories for the preparation of detailed bridge plans.
 - c. Make or cause to be made such soil surveys or subsurface investigations including borings and soil profiles and analyses thereof as may be required to furnish sufficient data for the design of the proposed improvement. Such investigations are to be made in accordance with the current requirements of the DEPARTMENT.
 - d. Make or cause to be made such traffic studies and counts and special intersection studies as may be required to furnish sufficient data for the design of the proposed improvement.
 - e. Prepare Army Corps of Engineers Permit, Department of Natural Resources-Office of Water Resources Permit, Bridge waterway sketch, and/or Channel Change sketch, Utility plan and locations, and Railroad Crossing work agreements.
 - f. Prepare Preliminary Bridge design and Hydraulic Report, (including economic analysis of bridge or culvert types) and high water effects on roadway overflows and bridge approaches.
 - g. Make complete general and detailed plans, special provisions, proposals and estimates of cost and furnish the LA with five (5) copies of the plans, special provisions, proposals and estimates. Additional copies of any or all documents, if required, shall be furnished to the LA by the ENGINEER at his actual cost for reproduction.
 - h. Furnish the LA with survey and drafts in quadruplicate of all necessary right-of-way dedications, construction easement and borrow pit and channel change agreements including prints of the corresponding plats and staking as required.

Note: Four copies to be submitted to the Regional Engineer

- i. Assist the LA in the tabulation and interpretation of the contractors' proposals
 - j. Prepare the necessary environmental documents in accordance with the procedures adopted by the DEPARTMENT's Bureau of Local Roads & Streets.
 - k. Prepare the Project Development Report when required by the DEPARTMENT.
- (2) That all reports, plans, plats and special provisions to be furnished by the ENGINEER pursuant to the AGREEMENT, will be in accordance with current standard specifications and policies of the DEPARTMENT. It is being understood that all such reports, plats, plans and drafts shall, before being finally accepted, be subject to approval by the LA and the DEPARTMENT.
- (3) To attend up to two (2) meetings/site visits with a representatives of the LA or the Department.
- (4) In the event plans or surveys are found to be in error during construction of the SECTION and revisions of the plans or survey corrections are necessary, the ENGINEER agrees that he will perform such work without expense to the LA, even though final payment has been received by him. He shall give immediate attention to these changes so there will be a minimum delay to the Contractor.
- (5) That basic survey notes and sketches, charts, computations and other data prepared or obtained by the Engineer pursuant to this AGREEMENT will be made available, upon request, to the LA or the DEPARTMENT without cost and without restriction or limitations as to their use.
- (6) That all plans and other documents furnished by the ENGINEER pursuant to this AGREEMENT will be endorsed by him and will show his professional seal where such is required by law.

The LA Agrees,

1. To pay the ENGINEER as compensation for all services rendered in accordance with this AGREEMENT, on the basis of the COST PLUS FIXED FEE COST ESTIMATE OF CONSULTANT SERVICES shown in EXHIBIT A.
 2. That payments due the ENGINEER for services rendered in accordance with this AGREEMENT will be made as soon as practicable after the services have been performed in accordance with the following schedule:
 - a. Upon receipt of monthly invoices from the ENGINEER and the approval thereof by the LA, monthly payments for the work performed shall be due and payable to the ENGINEER. Such payments to be equal to the value of the partially completed work minus all previous partial payments made to the ENGINEER.
- By Mutual agreement, partial payments, not to exceed 90 percent of the amount earned, may be made from time to time as the work progresses.
3. That, should the improvement be abandoned at any time after the ENGINEER has performed any part of the services provided for in paragraphs 1a, through 1h and prior to the completion of such services, the LA shall reimburse the ENGINEER for his actual costs plus 140 percent incurred up to the time he is notified in writing of such abandonment -"actual cost" being defined as in paragraph 2 of THE LA AGREES.
 4. That, should the LA require changes in any of the detailed plans, specifications or estimates except for those required pursuant to paragraph 4 of THE ENGINEER AGREES, after they have been approved by the DEPARTMENT, the LA will pay the ENGINEER for such changes on the basis of actual cost plus 140 percent to cover profit, overhead and readiness to serve -"actual cost" being defined as in paragraph 2 of THE LA AGREES. It is understood that "changes" as used in this paragraph shall in no way relieve the ENGINEER of his responsibility to prepare a complete and adequate set of plans and specifications.
-

It is Mutually Agreed,

1. That any difference between the ENGINEER and the LA concerning their interpretation of the provisions of this Agreement shall be referred to a committee of disinterested parties consisting of one member appointed by the ENGINEER, one member appointed by the LA and a third member appointed by the two other members for disposition and that the committee's decision shall be final.
2. This AGREEMENT may be terminated by the LA upon giving notice in writing to the ENGINEER at his last known post office address. Upon such termination, the ENGINEER shall cause to be delivered to the LA all surveys, permits, agreements, preliminary bridge design & hydraulic report, drawings, specifications, partial and completed estimates and data, if any from traffic studies and soil survey and subsurface investigations with the understanding that all such material becomes the property of the LA. The ENGINEER shall be paid for any services completed and any services partially completed in accordance with Section 4 of THE LA AGREES.
3. That if the contract for construction has not been awarded one year after the acceptance of the plans by the LA and their approval by the DEPARTMENT, the LA will pay the ENGINEER the balance of the engineering fee due to make 100 percent of the total fees due under this AGREEMENT, based on the estimate of cost as prepared by the ENGINEER and approved by the LA and the DEPARTMENT.
4. That the ENGINEER warrants that he/she has not employed or retained any company or person, other than a bona fide employee working solely for the ENGINEER, to solicit or secure this contract, and that he/she has not paid or agreed to pay any company or person, other than a bona fide employee working solely for the ENGINEER, any fee, commission, percentage, brokerage fee, gifts or any other consideration, contingent upon or resulting from the award or making of this contract. For Breach or violation of this warranty the LA shall have the right to annul this contract without liability.

IN WITNESS WHEREOF, the parties have caused the AGREEMENT to be executed in quadruplicate counterparts, each of which shall be considered as an original by their duly authorized officers.

Executed by the LA:

Coles County of the
(Municipality/Township/County)

ATTEST:

State of Illinois, acting by and through its

By _____

Clerk

By _____

(Seal)

Title County Board Chairperson

Executed by the ENGINEER:

ESI Consultants Ltd

753 Windsor Rd

Charleston, IL 61920

ATTEST:

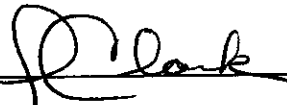
By 
Title Vice President

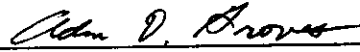
By 
Title Project Manager

Approved

Date
Department of Transportation

Regional Engineer

COLES COUNTY HIGHWAY DEPARTMENT

Richard A. Johnson, P.E – County Engineer
651 Jackson Street, Room 16
Charleston, IL 61920
Telephone 217-348-0527

COUNTY BRIDGE FUND PETITION

COLES COUNTY BOARD

Petition from: Seven Hickory Road District
13757 State Hwy 130
Charleston, IL 61920

Project No. 12-08.2016
Structure No. 015-3245

Location & Estimate of Costs: See Attached

Work to be performed: Removed material behind existing abutments and replace rotten timber back walls with new treated pine planks. Replace fill material with clay and aggregate and reopen to traffic.

Estimated Cost of Project: \$23,000.00

0.02% of Assessed Valuation of City or Township \$ 3,567.00

Whereas all requirements of 605 ILCS 5/5-501, Chapter 121 of the Illinois Statutes have been satisfied concerning aid from the County Board, I hereby petition the Coles County Board to appropriate a sufficient sum to match a portion of the estimated cost of the proposed bridge/ drainage project.

Signed: _____
Highway Commissioner

Approved by the Coles County Board
this 9th day of November, 2016.

Amount Approved for Appropriation
from the County Bridge Fund:

Board Chair

\$ 11,500.00

Attest: _____
County Clerk

Estimate of Costs

Cost Share with Seven Hickory Twp.

TR-43 (CR 1600N)
Structure 015-3245

Estimate of Costs:

<u>Item</u>	<u>Quantity</u>	<u>Hrs./ Units</u>	<u>Rate</u>	<u>Total</u>
Treated Pine Planks (3.5"x10"x20')	8	each	\$110.90	\$887.20
Treated Pine Planks (3.5"x10"x24')	8	each	\$147.20	\$1,177.60
Trackhoe w/Operator	1	48	\$250.00	\$12,000.00
Backhoe w/Operator	1	48	\$85.00	\$4,080.00
Walk behind compactor	1	24	\$55.00	\$1,320.00
Plastic Sheeting	1	9	\$50.00	\$450.00
Fill Material (clay)	120	tons	\$12.00	\$1,440.00
CA-6, Crushed Stone	64.84	tons	\$10.75	\$697.03
				<u>\$22,051.83</u>

Coles County Portion (1/2): \$11,025.92

SEVEN HICKORY



PROJECT LOCATION

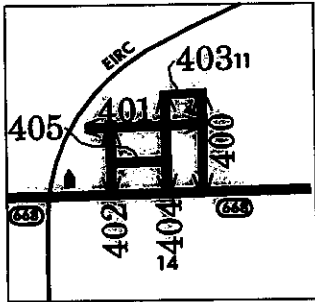

FAIRGRANGE
T 13 N R 9 E

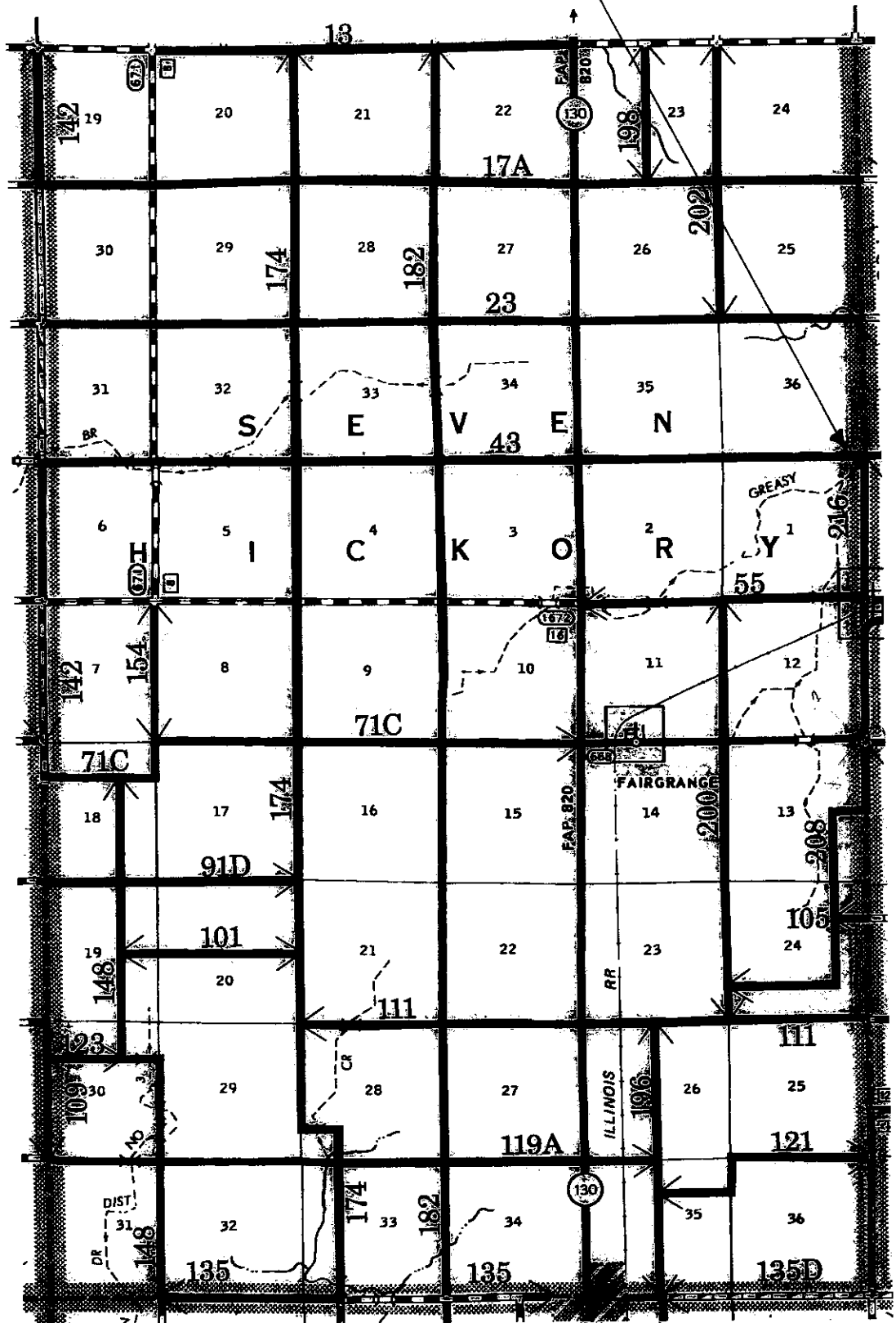

COLES COUNTY HIGHWAY DEPARTMENT

Richard A. Johnson, P.E – County Engineer

651 Jackson Street, Room 16
Charleston, IL 61920
Telephone 217-348-0527

COUNTY BRIDGE FUND PETITION

COLES COUNTY BOARD

Petition from: Ashmore Road District Project No. 01-10.2016
P.O. Box 335
Ashmore, IL 61912 Structure No's. 3152, 3233, 3263

Location: See Attached Map

Work to be performed: Place riprap material under existing structures to reduce the scouring adjacent to the substructures of the bridges.

Estimated Cost of Project: \$6,100.00

0.02% of Assessed Valuation of City or Township \$ 5,099.00

Whereas all requirements of Article 5-501, Chapter 121 of the Illinois Statutes have been satisfied concerning aid from the County Board, I hereby petition the Coles County Board to appropriate a sufficient sum to match a portion of the estimated cost of the proposed bridge/drainage project.

Signed: _____
Highway Commissioner

Approved by the Coles County Board

this _____ day of _____, 20__

Amount Approved for Appropriation
from the County Bridge Fund:

Board Chair

\$ 3,050.00

Attest: _____
County Clerk

Project Completed _____, 20__

Actual Amount Used _____

Estimate of Costs

Cost Share with Ashmore Twp.

Structures: 015-3233, 015-3263, 015-3152

Estimate of Costs:

<u>Item</u>	<u>Quantity</u>	<u>Hrs./ Units</u>	<u>Rate</u>	<u>Total</u>
3/4 Ton Truck	1	24	\$13.81	\$331.44
Dump Truck, 50,000 lbs	1	24	\$49.09	\$1,178.16
Mini Skid Steer Rental	1	week	\$600.00	\$600.00
Backhoe (99hp)	1	24	\$51.56	\$1,237.44
Laborer/Operator	4	24	\$15.00	\$1,440.00
Riprap	60	tons	\$22.00	\$1,320.00
				<u>\$6,107.04</u>

Coles County Portion (1/2): \$3,053.52

ASHMORE

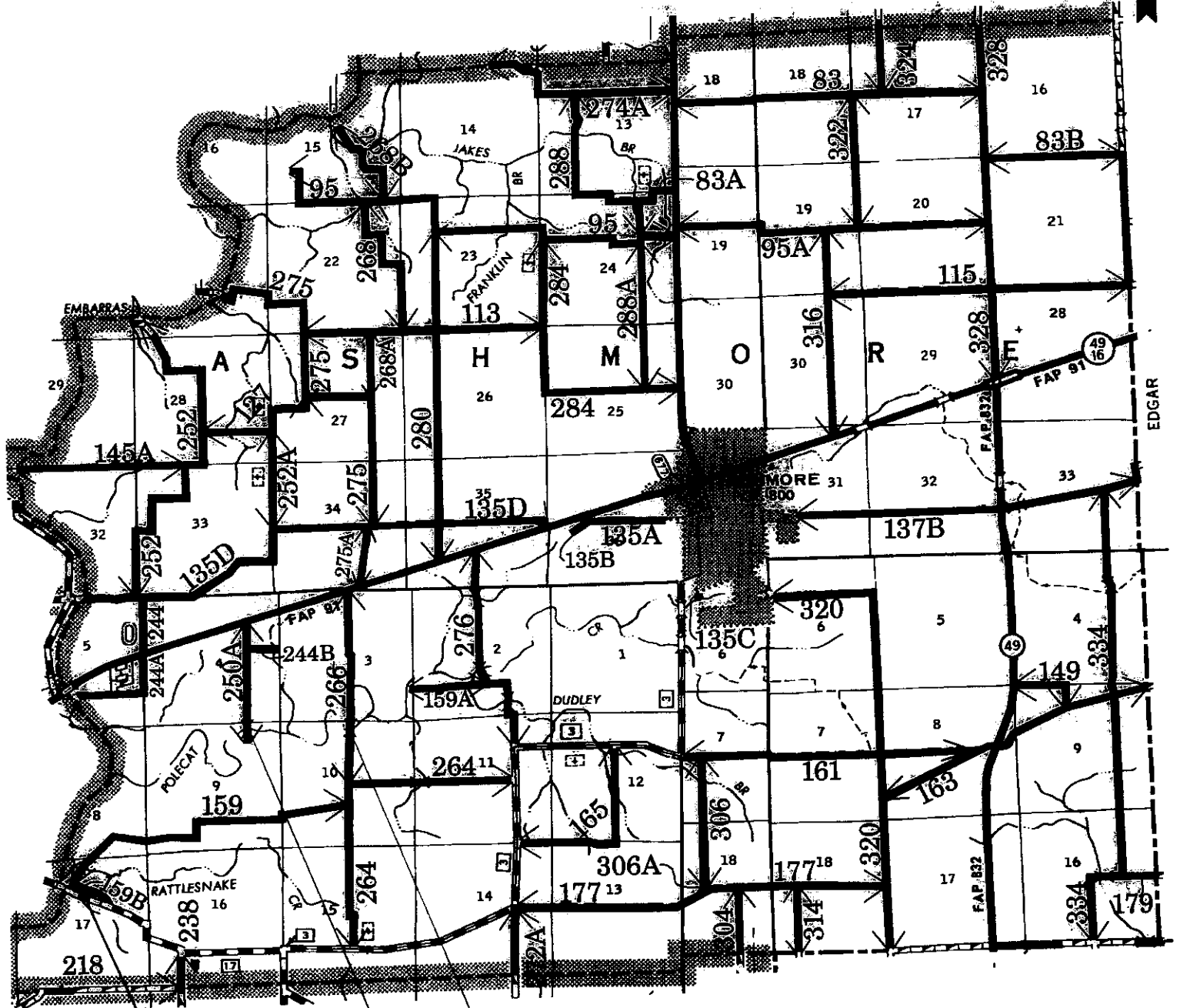

015-3263

015-3233

015-3152